

FLOOR THREE

+ ROOFTOP PLAZA

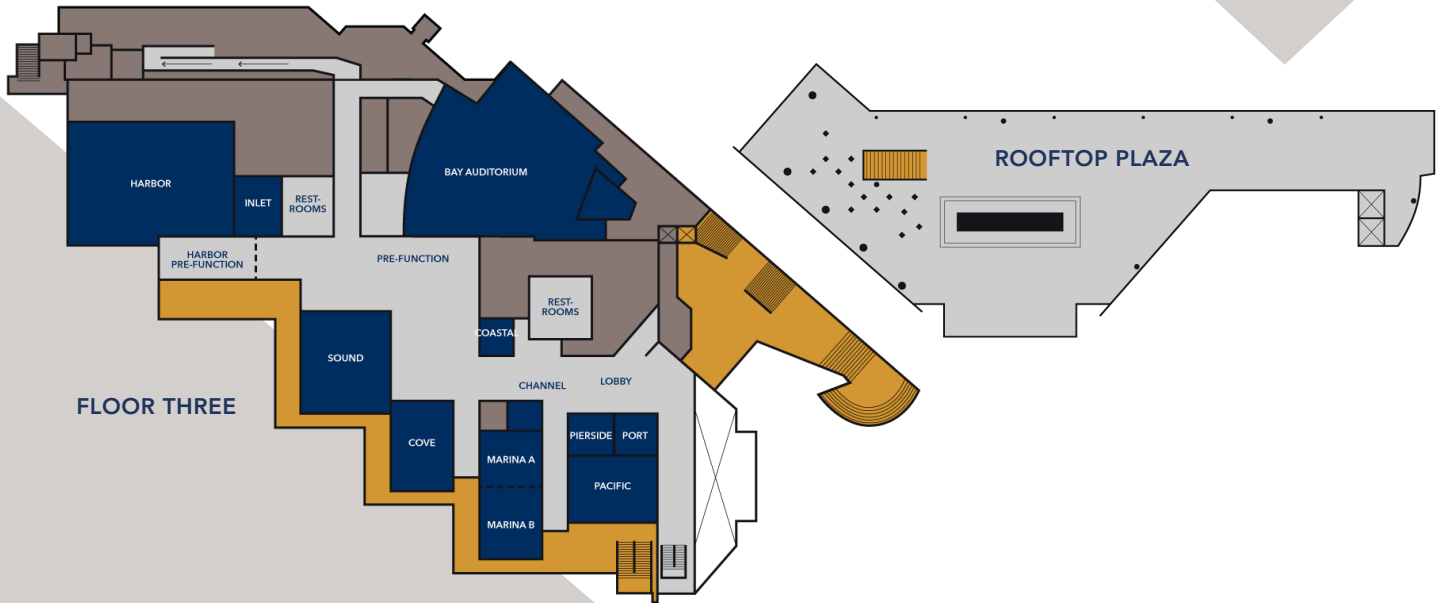

SCAN FOR
360 TOUR



	SQ FT	RECEPTION	ROUNDS	CLASSROOM	THEATER	CONFERENCE	DIMENSIONS
PACIFIC	1,116	70	46	46	70	22	L 20.9' X W 38.2'
MARINA	1,651	150	98	100	150	48	L 59' X W 28.4'
MARINA A	723	70	40	40	58	20	L 32.8' X W 28.4'
MARINA B	928	90	60	54	90	20	L 26.1' X W 28.3'
COVE	1,160	90	60	60	90	26	L 39' X W 28.4'
SOUND	1,944	180	110	96	170	40	L 47.8' X W 40.9'
BAY AUDITORIUM	5,358	-	-	330	-	-	-
HARBOR	4,156	450	275	232	400	68	L 75.8' X W 52.9'
INLET	593	50	40	30	44	20	L 27.1' X W 21.3'
COASTAL	260	-	11	15	23	12	L 17.8' X W 15.3'
CHANNEL	220	-	11	15	23	8	L 13.8' X W 16.1'
PIERSIDE	391	-	11	15	23	12	L 20.8' X W 18.9'
PORT	366	-	11	15	23	12	L 19.3' X W 18.9'
PRE-FUNCTION LOBBY	6,121	500	-	-	-	-	-
ROOFTOP PLAZA	9,000	500	150	-	-	-	-

FLOOR ONE + FLOOR TWO



SCAN FOR
360 TOUR

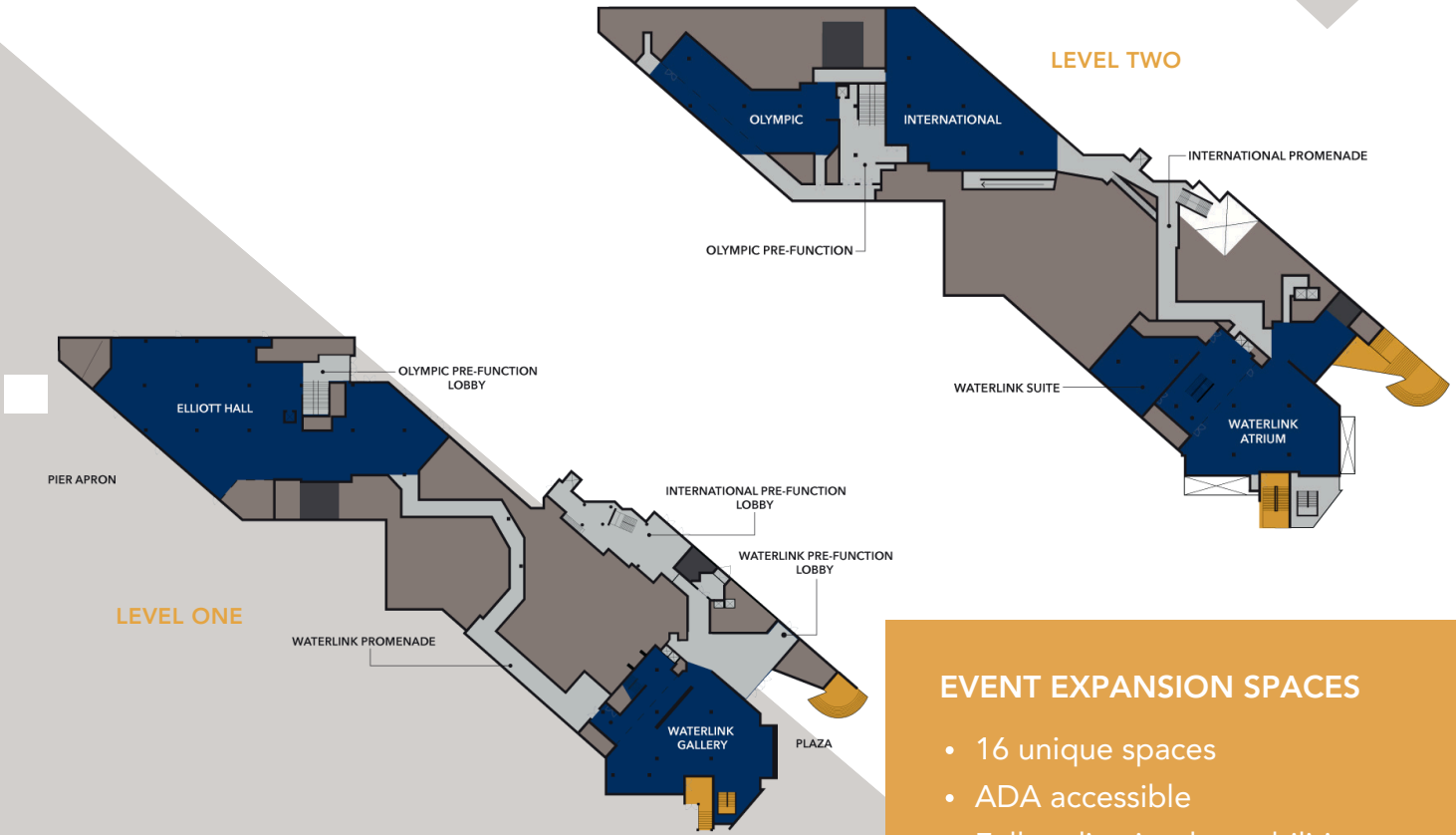

EVENT EXPANSION SPACES

- 16 unique spaces
- ADA accessible
- Full audio visual capabilities
- Various restrooms available on all floors

	SQ FT	RECEPTION	ROUNDS	CLASSROOM	THEATER
INTERNATIONAL	10,600	750	520	300	600
OLYMPIC	6,500	500	320	200	300
WATERLINK ATRIUM	9,800	700	480	320	600
WATERLINK GALLERY	8,800	600	500	250	475
WATERLINK SUITE	2,700	250	150	110	220
ELLIOTT HALL	15,000	1,800	950	600	1,300
PIER APRON	11,400	1,500	-	-	-